

Materials in Box

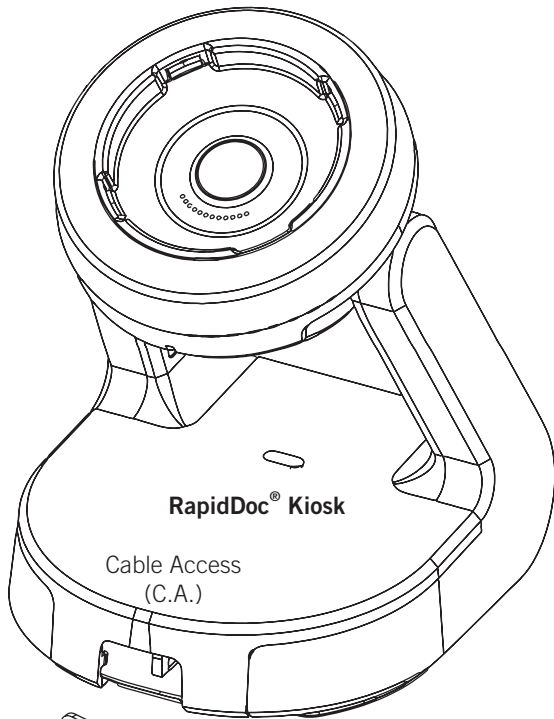

RapidDoc® Kiosk

Cable Access (C.A.)

C.A. Cover (Minimal Cables)

C.A. Cover (No Cables)

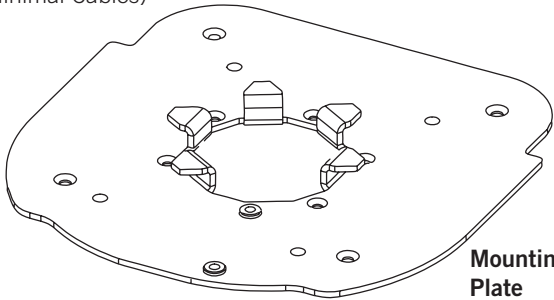

Mounting Plate

Use only power supply with output ratings 24VDC max., 2.7A max., of PS2 or LPS

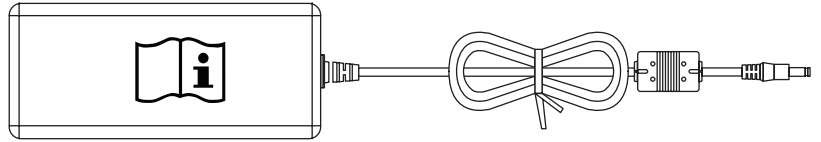

"If the Kiosk is not mounted to a counter or table it may fall," causing damage to the Kiosk or a person. USB cables may be disconnected as it moves around a surface. See page 9 for mounting instructions.

The applied nameplate is located at the bottom of the product.

Equipment is only suitable for mounting at heights < 2 meters.

The socket-outlet (power adaptor) shall be installed near the EQUIPMENT and shall be easily accessible.

Alcohol Wipes (10)

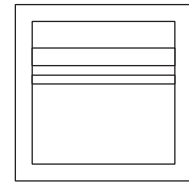

Red Handle Tool



(2) Security Screws, Metric, M4 X 10mm Round Hd, Torx, W/Lock Washer



Access Card (5)

Authorization Card



(4) Mounting Screws, 6 X 5/8", 100° Flat Hd Phil, Zinc

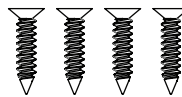

185-00528 Through-Hole Mounting Accessory (Sold separately)

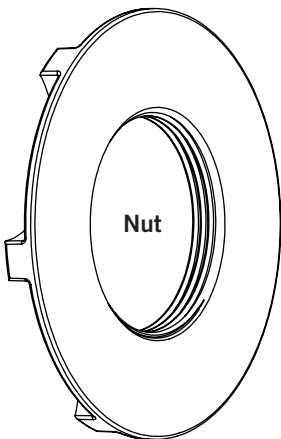

Nut

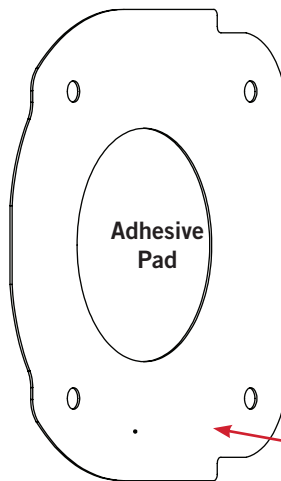

Adhesive Pad

PSA with paper release liner this surface only.

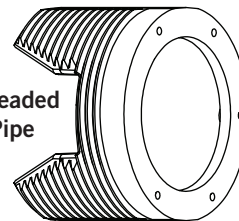

Threaded Pipe



See page 9 for mounting instructions.

(5) Screws M3x8mm Long, Flat-Head-Phil



# REMOVING THE LID

**1** Lift up the front of the lid (above the ArmorActive logo).

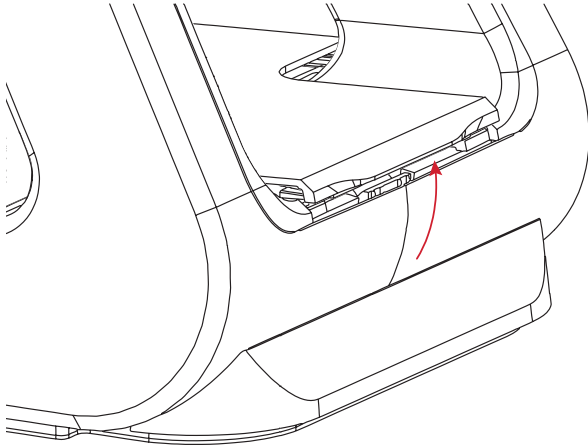

**2** Slide the lid back, using care when removing the lid as not to damage the RFID cable.

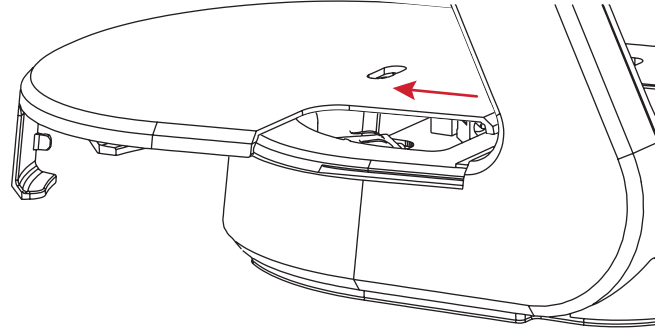

# CABLE ACCESS COVER

**1** With the lid off of the kiosk base, place the Cable Access Cover into the opening from the inside.

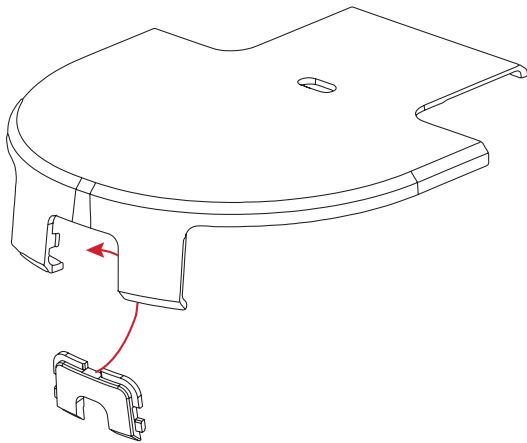

**2** Press until it clicks into place.

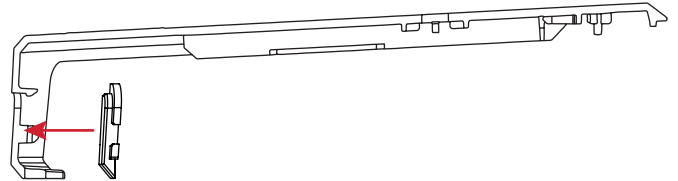

# REPLACING THE LID

**1** Tuck the RFID cable into the void in the base and place the lid on the kiosk base.

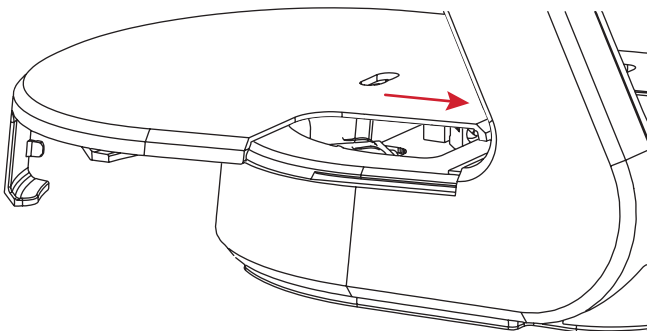

**2** Slide the lid into place and press down on the lid.

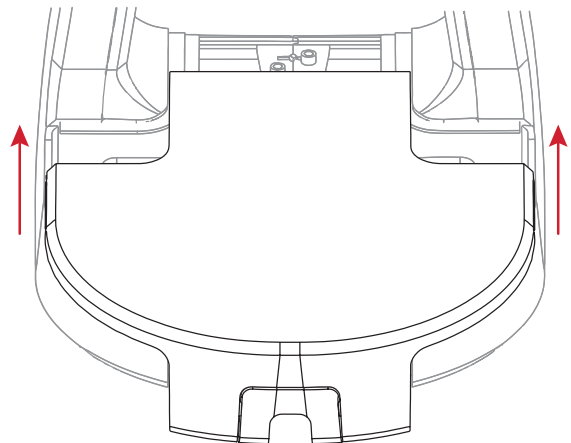

**1** Using the mounting screws, place the mounting plate in the desired location. See Page 9 for a Mounting Plate drill template.

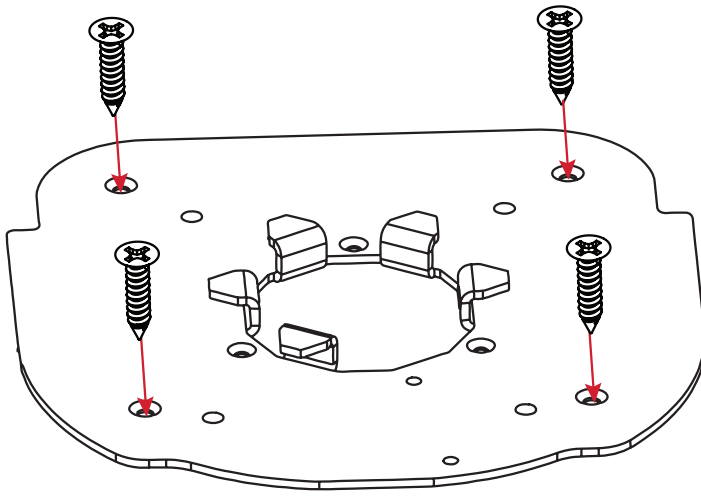

**2** Place the kiosk by lining up the opening on the bottom of the kiosk with the teeth on the mounting plate.

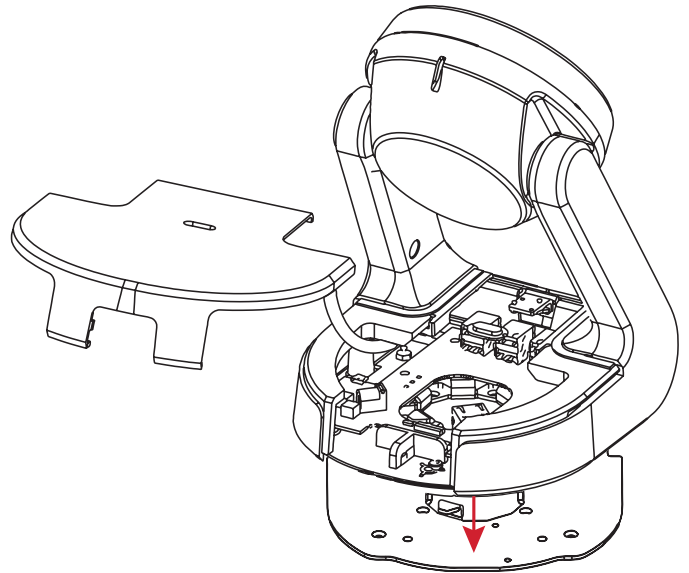

**3** Lock the kiosk into place by rotating it counter clockwise on the plate.

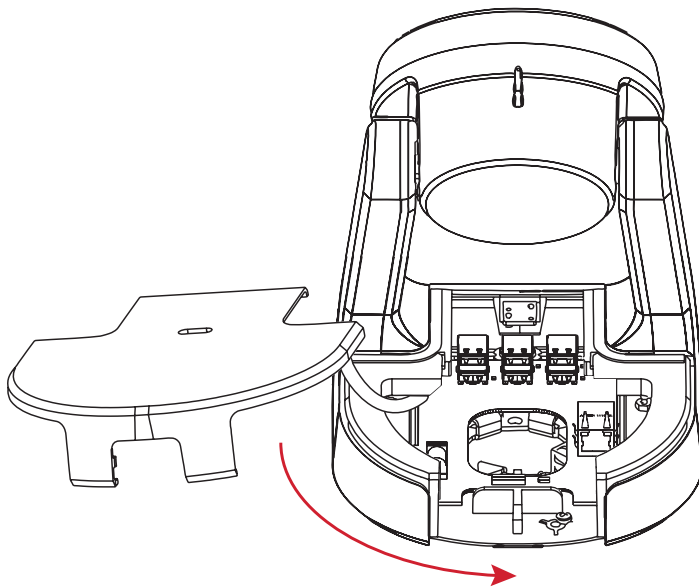

**4** Secure the kiosk to the mounting plate using the two security screws and the Red Handle Tool.

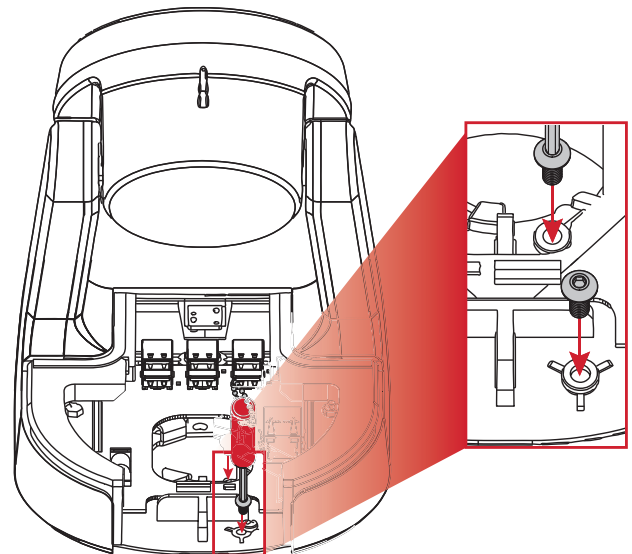

1

1. Through Hole Cable Routing
2. Table Top Cable Routing
3. Six USB Ports (Pro version only)
4. Ethernet (Pro version only)
5. Power

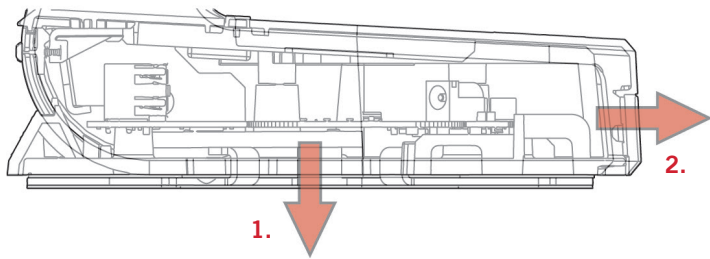

2

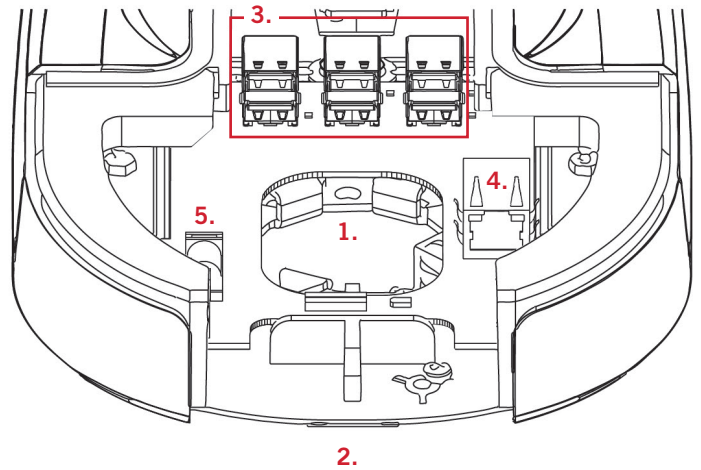

# VHB MOUNTING

- 1 Clean the surface you are mounting on with the Alcohol wipes included in the box. Peel the film on the VHB on the bottom of the kiosk.

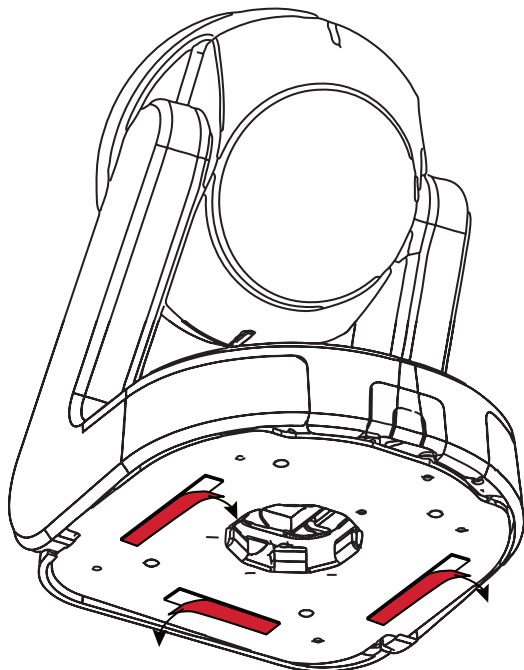

- 2 Place in desired location and firmly press down for full adhesive contact. Allow 24 hours for full VHB adhesion.

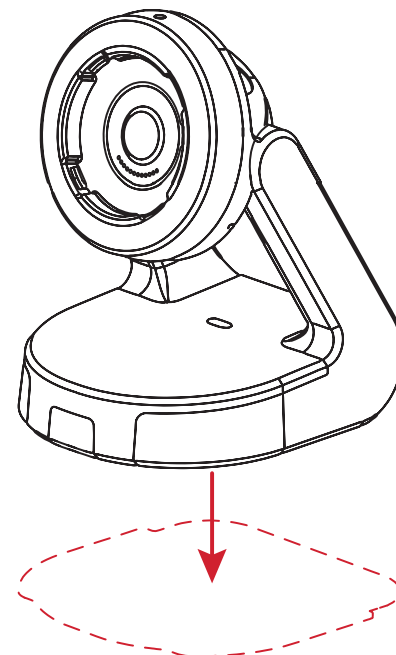

- 1** Make sure the RapidDoc® RFID Module is powered and ready.

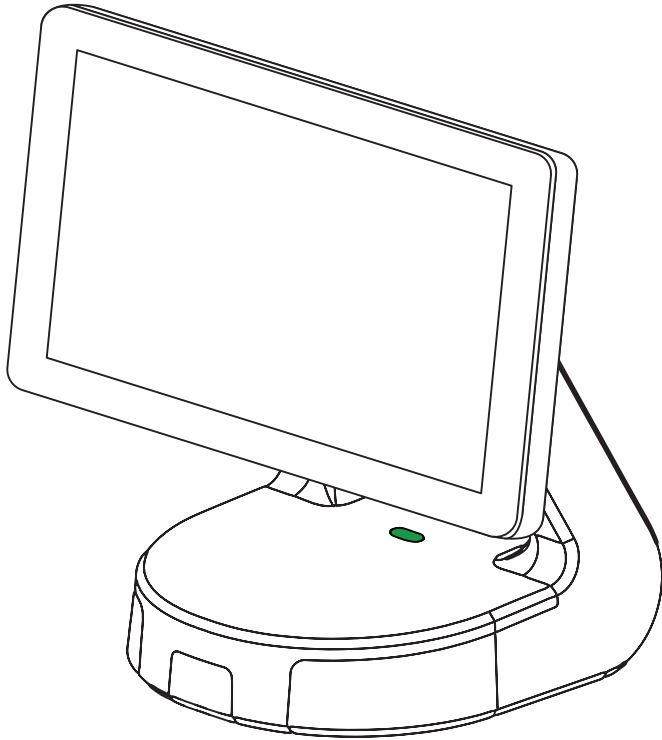

- 2** Place the RFID Authorization Card on the RFID Module until the LED flashes.

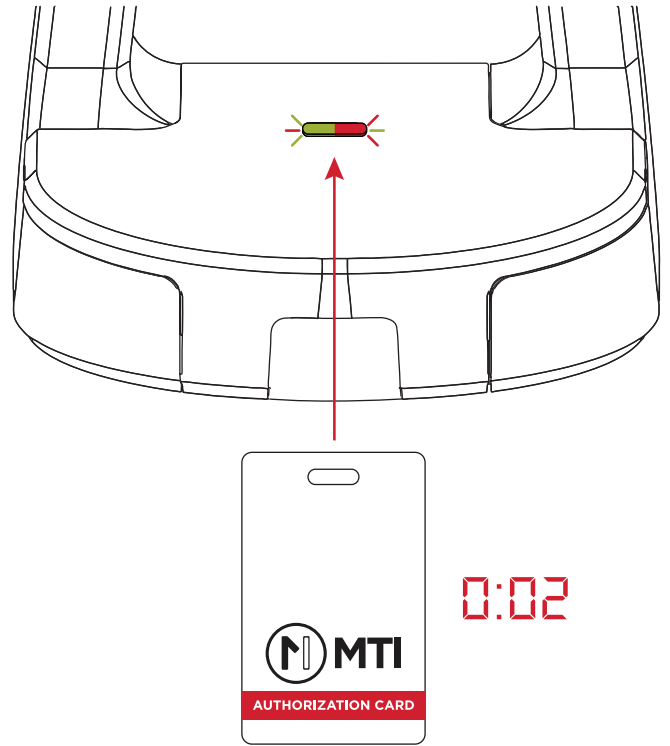

- 3** Place a RFID Access card on the RFID Module until LED flashing stops and returns to solid green.

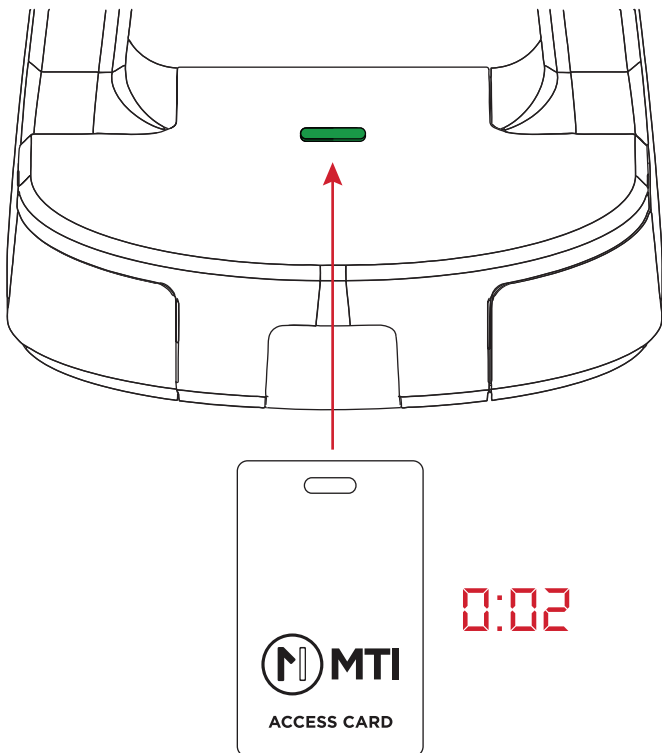

- 4** If no Access Card is detected, the Base will return to normal condition waiting for registered Access Card to unlock the Base. The Base can register a maximum of 20 Access cards. The process will need to be repeated for each card. If a 21st card is registered, the first registered card will be deregistered.

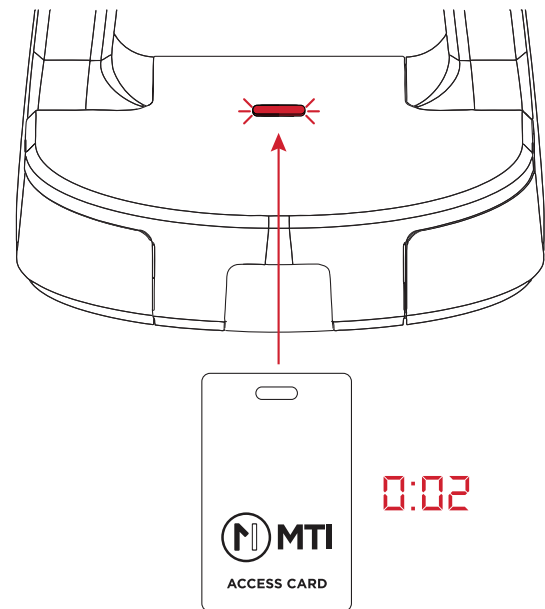

**IF AUTHORIZATION CARD IS LOST OR STOLEN,  
CONTACT CUSTOMER SERVICE FOR REPLACEMENT.**

# REMOVING THE ENCLOSURE (OR TABLET) VIA RFID

- 1** Place the RFID Access Card until the base clicks. **NOTE:** Do not grab the tablet until after you hear the click.

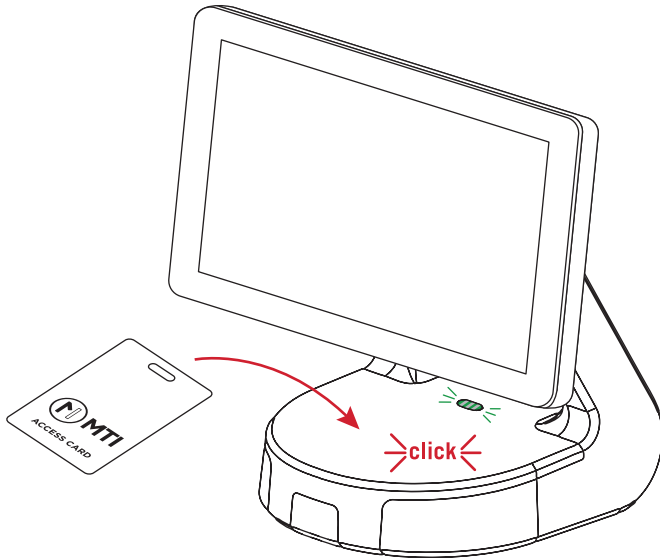

- 2** Remove the tablet using one hand on the bottom left or right hand corner.

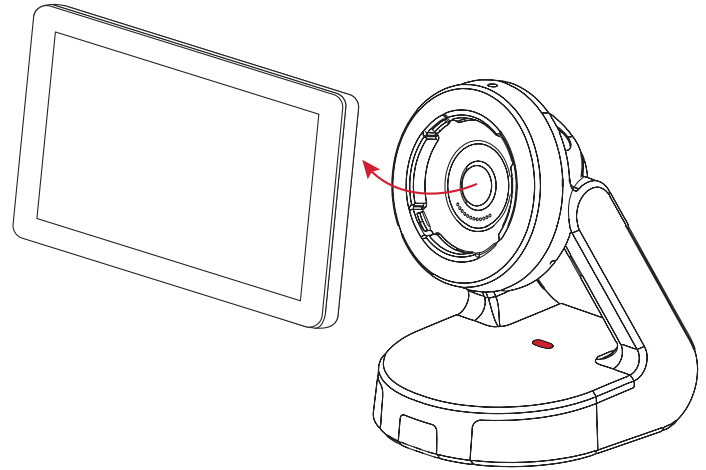



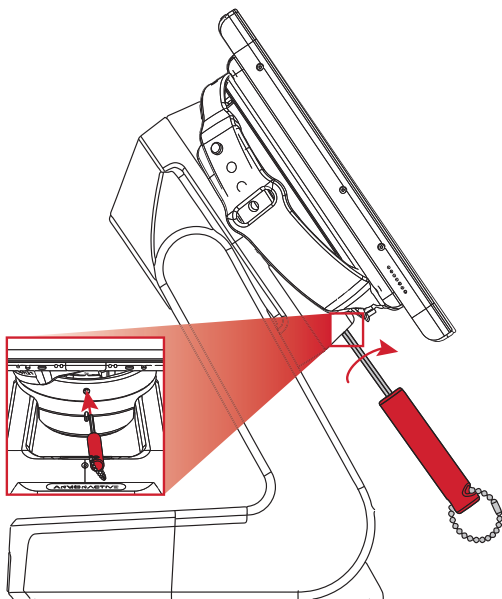

# REMOVING THE ENCLOSURE (OR TABLET) MANUALLY

- 1** Insert the Red Handle Tool into the security screw hole at the side of the RapidDoc® base-disk under the tablet. Turn the Red Handle Tool clockwise until resistance is felt (about halfway) and hold. **NOTE:** Do not grab the tablet until after you twist the Red Handle Tool.

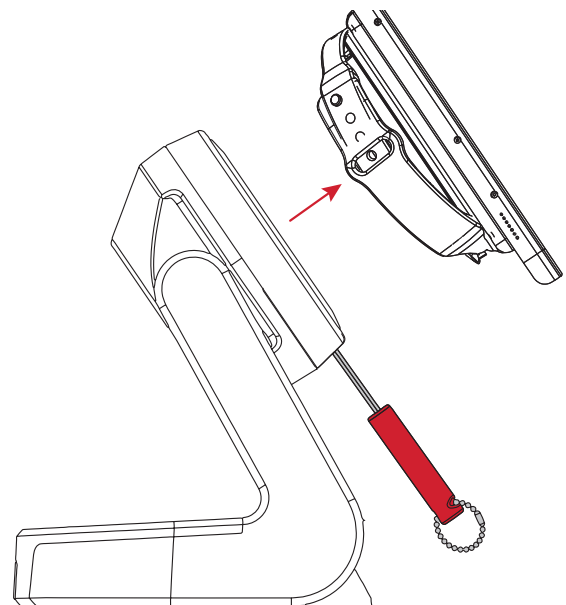

- 2** While holding the Red Handle Tool, remove the tablet using one hand on the bottom left or right hand corner.

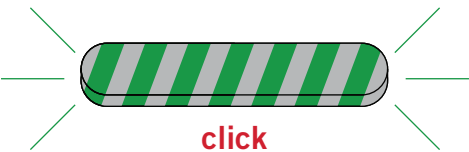
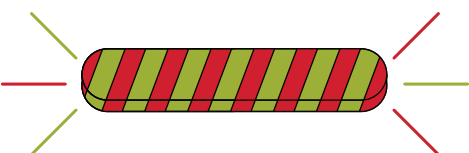

Visual Reference	System Status	Condition
	Solid Green LED	Tablet docked
	Solid Red LED	Tablet removed
 <p style="text-align: center; color: red;">click</p>	Flashing Green with audible click	Tablet ready for removal
	Flashing Yellow-Green and Red	Ready to register an Access card
	Flashing Red	 <p><b>Multiple undock attempts</b> If an Access Card is swiped more than 10 times within 2 minutes, the LED will flash Red and not allow undock attempts for 2 minutes.</p>

**1** The base can register a maximum of 20 Access cards.

Example:

ACCESS005
ACCESS004
ACCESS003
ACCESS002
ACCESS001

**NOTE:** The above grid is a conceptual visual representation of the Electronic Register.

**2** If a 21st card is registered, the first registered card will be deregistered.

Example:

ACCESS006
ACCESS005
ACCESS004
ACCESS003
ACCESS002

**3** If a card is **lost or stolen**:

Example:

ACCESS005
ACCESS004
<b>ACCESS003</b>
ACCESS002
ACCESS001

**4** Take any of the remaining access cards and register it 20 consecutive times:

Example:

ACCESS001
ACCESS001
ACCESS001
ACCESS001
ACCESS001

**5** Then re-register the remaining cards plus the new one ordered through Customer Service. Example:

Example:

ACCESS006
ACCESS005
ACCESS004
ACCESS002
ACCESS001

**6**

**IF AUTHORIZATION CARD IS LOST OR STOLEN,  
CONTACT CUSTOMER SERVICE FOR REPLACEMENT.**



Print this document at 100% (or 'Actual Size') to assist in placing the RapidDoc® Mounting Plate.

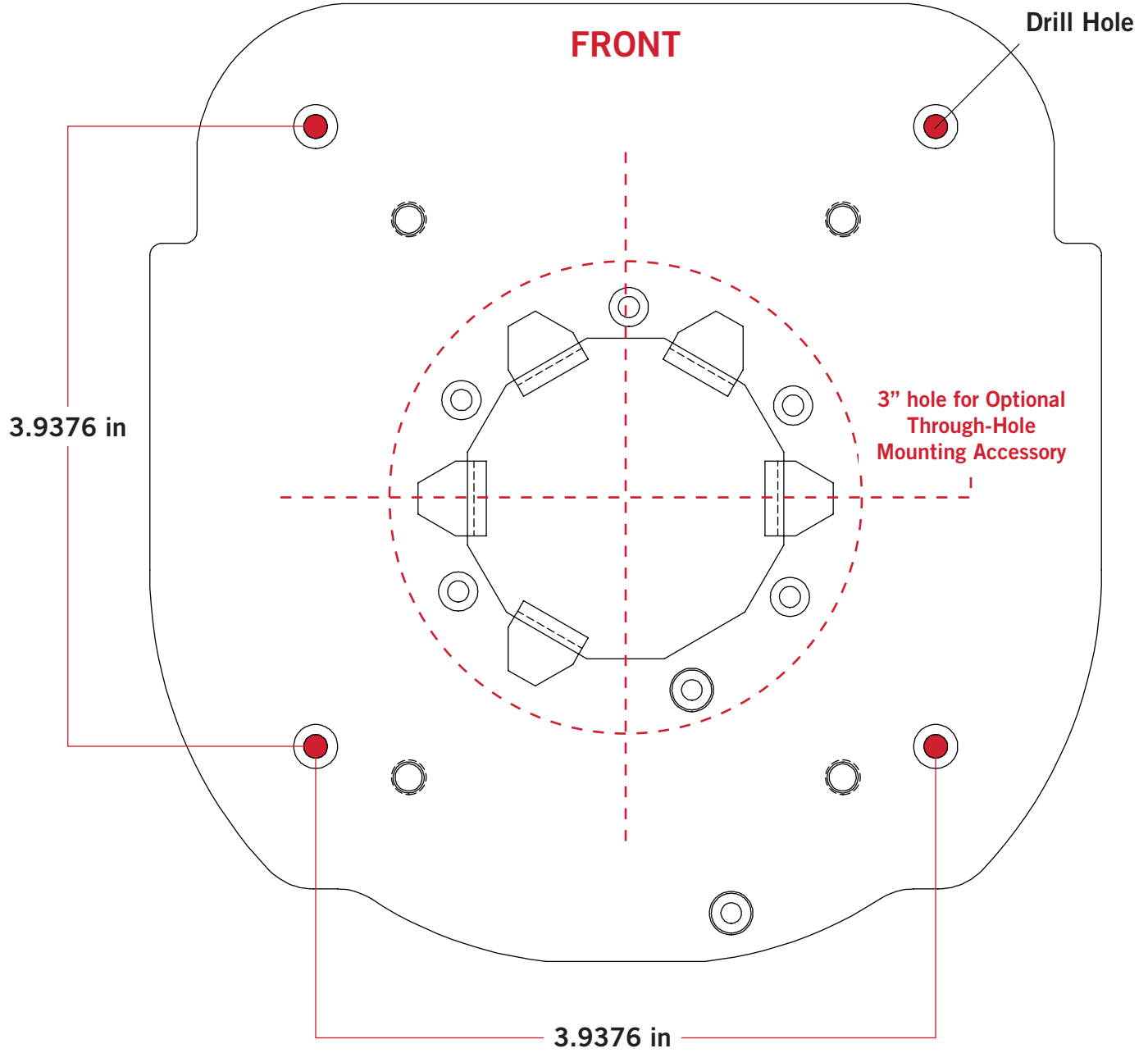

- 1** **NOTE: The Through-Hole Mounting Accessory is sold separately.** Peel the film on the included adhesive pad and adhere it to the underside of the mounting plate.

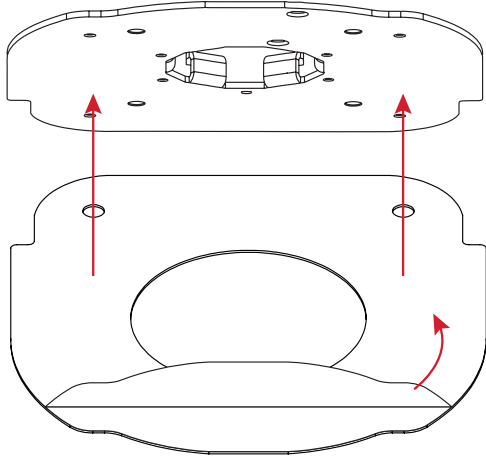

- 2** Attach the threaded pipe to the mounting plate with the 5 included screws.

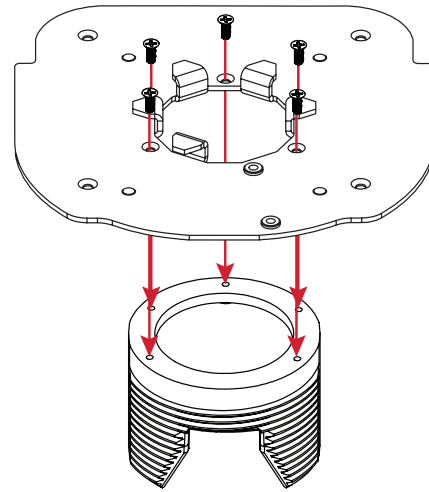

- 3** Place the assembly into a pre-drilled hole 3" wide.

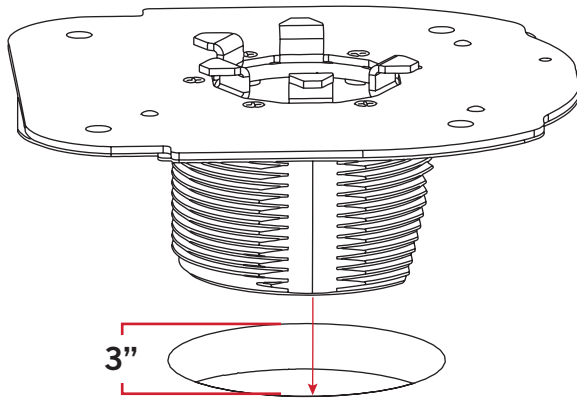

- 4** Secure into place by twisting the nut over the threaded pipe.

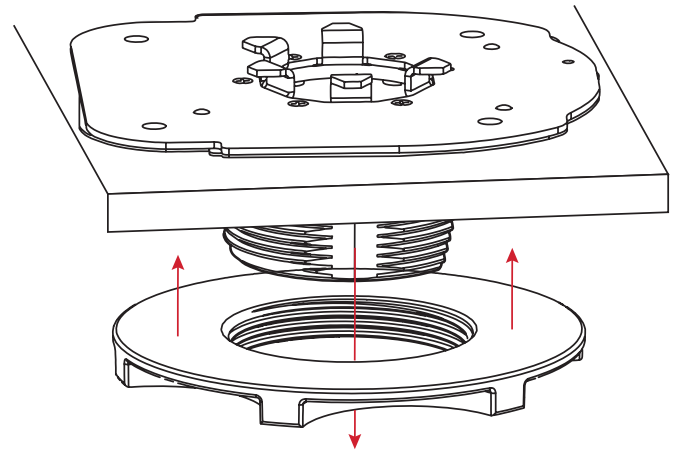

- 5** Place the kiosk by lining up the opening on the bottom of the kiosk with the teeth on the mounting plate. Lock the kiosk into place by rotating it counter clockwise on the plate.

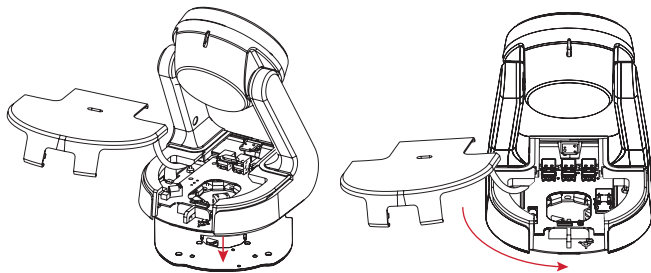

- 6** Secure the kiosk to the mounting plate using the two security screws and the Red Handle Tool.

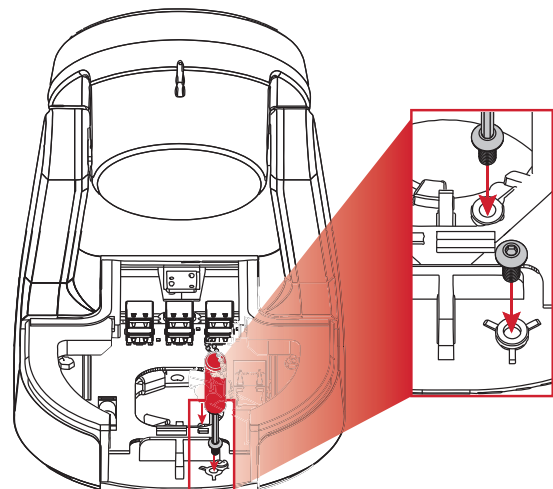

## Federal Communication Commission interference statement

This equipment has been tested and found to comply with the limits for a Class B digital device, pursuant to part 15 of the FCC rules. These limits are designed to provide reasonable protection against harmful interference in a residential installation. This equipment generates, uses and can radiate radio frequency energy and, if not installed and used in accordance with the instructions, may cause harmful interference to radio communications. However, there is no guarantee that interference will not occur in a particular installation. If this equipment does cause harmful interference to radio or television reception, which can be determined by turning the equipment off and on, the user is encouraged to try to correct the interference by one or more of the following measures: -Reorient or relocate the receiving antenna. -Increase the separation between the equipment and receiver. -Connect the equipment into an outlet on a circuit different from that to which the receiver is connected. -Consult the dealer or an experienced radio/TV technician for help.

## FCC Caution

This device complies with Part 15 of the FCC Rules. Operation is subject to the following two conditions:

1. This device may not cause harmful interference and
2. This device must accept any interference received, including interference that may cause undesired operation

## RF Exposure Warning

The equipment complies with RF exposure limits set forth for an uncontrolled environment. The antenna(s) used for this transmitter must not be co-located or operating in conjunction with any other antenna or transmitter.

You are cautioned that changes or modifications not expressly approved by the party responsible for compliance could void your authority to operate the equipment.

## Technical Data:

Operating Temperature 0 - 40 °C



Si le kiosque n'est pas monté sur un comptoir ou une table, il peut tomber, causant des dommages au kiosque ou à une personne. De plus, les câbles USB peuvent être déconnectés lorsqu'ils se déplacent sur une surface. Voir la page 3 des instructions de montage.

L'équipement convient uniquement pour un montage à des hauteurs <2 mètres.

La plaque signalétique appliquée est située au bas du produit.

Utilisez uniquement une alimentation 185-00282 avec des puissances de sortie 24VDC max., 2,7 A max, PS2 ou LPS

La prise de courant (adaptateur secteur) doit être installée près de l'ÉQUIPEMENT et doit être facilement accessible.